

# User Manual

A5 & S6 Open Heavy Duty Rear Rack

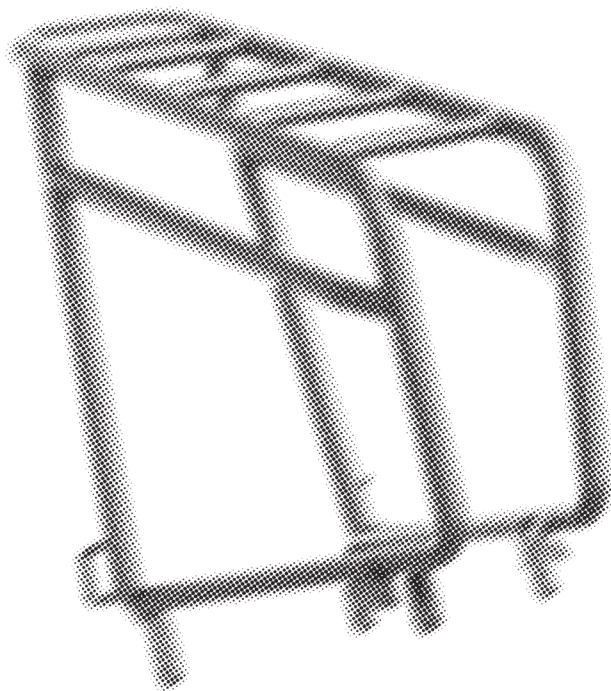

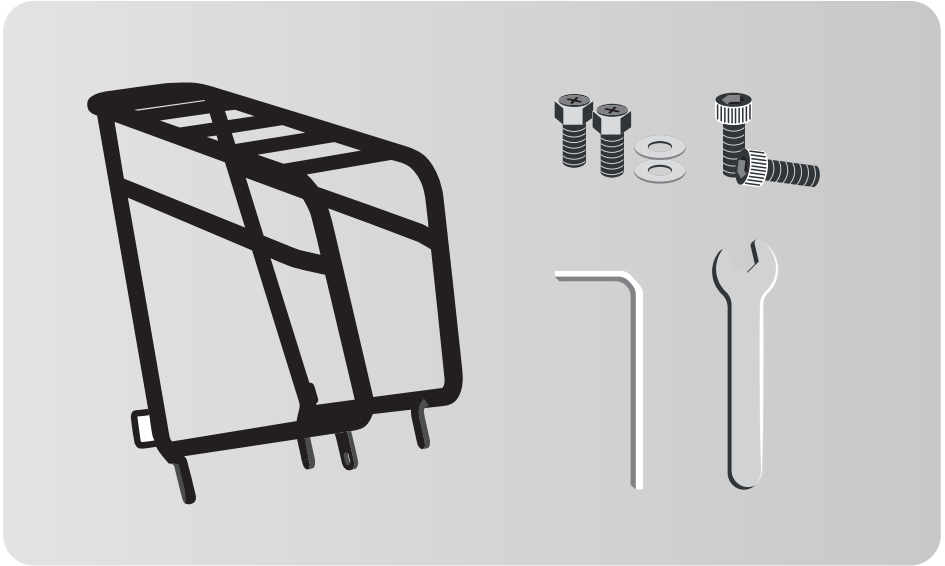

↑ Tools & parts in the box:

- A5 & S6 Open Heavy Duty Rear Rack
- Hex head screws (12 mm / x2) + Washers (x2)
- Socket head screws (16 mm / x2)
- Allen key N°4
- Wrench (8mm)

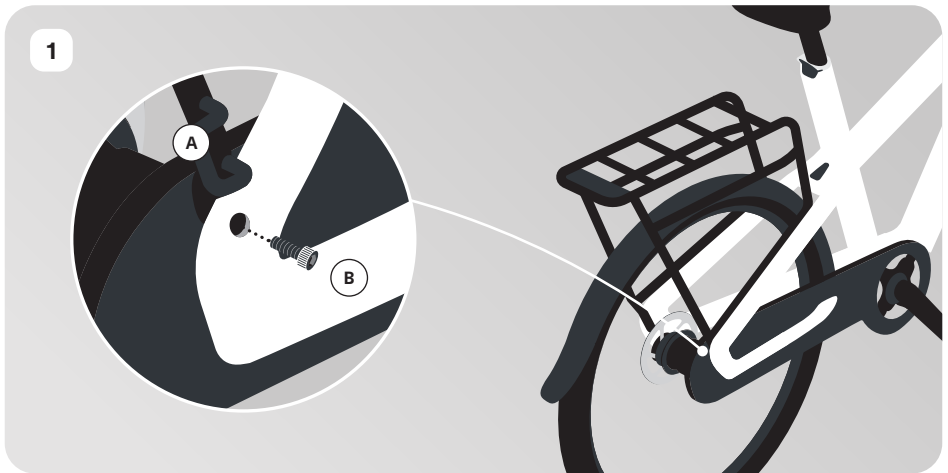

- ↑ Make sure the rack stays (A) are positioned on the inside of the rear dropouts (B), and loosely screw the two socket head screws with your hands to hold the rack in place

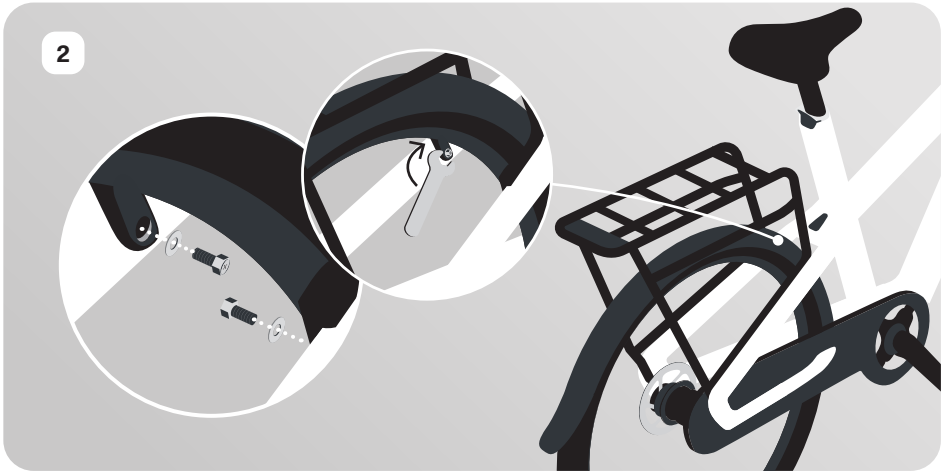

↑ Screw the two washers and hex head screws with your hands and tighten using the wrench (4Nm).

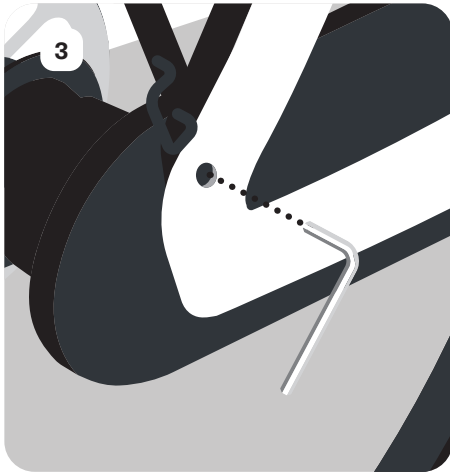

↑ Tighten the two socket head screws using Allen key N°4. Make sure all screws are tightened properly. The recommended torque is 4Nm.



↑ Ready to ride!

#### Specifications:

- Aluminium construction.
- Designed to carry up to 27 Kg.
- Compatible with Vanmoof recommended specific child seats.
- Does not include a light.
- The rear rack is compatible with 24" x 2.0" (52/507) wheel size and tires.
- Compatible with VanMoof Large Pannier Bag on right hand side only.



#### IMPORTANT SAFETY INSTRUCTIONS

- 1. WARNING:** Read and follow all product instructions and warnings, including the installation and care manual for this product, the installation and care manual for a VanMoof compatible child seat if you want to install one, and the bicycle use and care manual.
- 2. WARNING:** Maximum load capacity is 27 kilograms or 60 pounds. Do not exceed the bicycle manufacturer's permissible maximum load.
- 3. WARNING:** Only use with child seats specifically recommended by VanMoof as compatible for use with the VanMoof Heavy Duty Rear Rack.
- 4. WARNING:** Check with a VanMoof certified bike doctor for the child seat installation. Not having a proper installation method may lead to serious injury.
- 5. WARNING:** Only carry a child who is able to hold his or her head up while wearing a correctly sized bicycle helmet. Follow the age and weight limits for the VanMoof compatible child seat.
- 6. WARNING:** Bicycle operators should be at least 18 years old to use this product in combination with a VanMoof compatible child seat to transport children.
- 7. WARNING:** Make sure your bicycle is stable and under control when loading and unloading children.
- 8. WARNING:** The bicycle to which the Heavy Duty Rear Rack and VanMoof compatible child seat are mounted must be in good working order, of a size and type appropriate for the operator and additional load.
- 9. WARNING:** Do not attach additional items or accessories to VanMoof Heavy Duty Rear Rack while using a VanMoof compatible child seat.
- 10. WARNING:** Check with your bicycle's manufacturer to verify proper fit, mounting points, bicycle cargo load capacity, and compatibility for carrying cargo.
- 11. WARNING:** Do not modify, disassemble or otherwise tamper with the Rear Rack in any way.
- 12. WARNING:** The VanMoof Rear Rack is not suitable for towing trailers of any sort.
- 13. WARNING:** The bicycle may behave differently (particularly with regard to steering and braking) when the Heavy Duty Rear Rack and VanMoof compatible child seat are loaded. Use caution while driving.
- 14. WARNING:** Position reflectors and lights so that they are not obstructed when the VanMoof Heavy Duty Rear Rack is loaded.
- 15. WARNING:** Make sure your load is evenly balanced and secure before every ride (i.e. no loose straps to get caught in the wheels).
- 16. WARNING:** Do not use the Heavy Duty Rear Rack to transport pets.
- 17. WARNING:** Do not use the Heavy Duty Rear Rack to transport children without also using a VanMoof recommended child seat.
- 18. WARNING:** Bicycle operators and children should always wear appropriately sized safety helmets that meet nationally recognized standards.
- 19. WARNING:** Never leave a child alone unattended in a VanMoof compatible child seat.
- 20. WARNING:** When walking your bicycle with a child in a VanMoof compatible child seat, hold the Heavy Duty Rear Rack with one hand and hold the handlebar with the other hand.
- 21. WARNING:** Tighten the rack and VanMoof compatible child seat fasteners securely before each use and check them frequently.
- 22. WARNING:** Ensure all screws are properly torqued (4Nm).

#### Ongoing Maintenance:

Improper installation of screws may lead to product failure, causing serious injury. Do not exceed specified torque values. Periodically inspect screws and retighten if required. Frequently check to make sure that all the carrier hardware is properly torqued per these instructions. Check to make sure that the carrier mounting screws are properly tightened and secure the carrier to the bicycle frame. Periodically check for any signs of cracking or failure and discontinue use if carrier is damaged.

#### Warranty:

To view the warranty for this product, please visit our website at [help.vanmoof.com](http://help.vanmoof.com)

VANMOOF

